

Permanente

Permanente Vessel Bathroom Sink VESSEL-PERM



THOMPSON

FEATURES

- Handcrafted, Circular hand hammered design with unique artisan detailing that adds texture and character to any space
- Rigorously tested to ensure no puddling or leaking
- Coordinating drain available, sold separately
- Base Material: Copper
- Finish Profile: Evolved (To learn more about the sink's finish, as well as care and maintenance recommendations, please refer to our [Finish Guide](#))
- Easy to clean and maintain
- Limited Lifetime Warranty crafted for quality and backed for life



DIMENSIONS & WEIGHT

Outer Dimensions

- Length: 17"
- Width: 14"
- Depth: 7"

Inner Dimensions / Bowl Area

- Length: 15"
- Width: 12"
- Depth: 7"
- Drain 1 1/2 "
- Sink Weight: n/a
- Shipping Weight: n/a

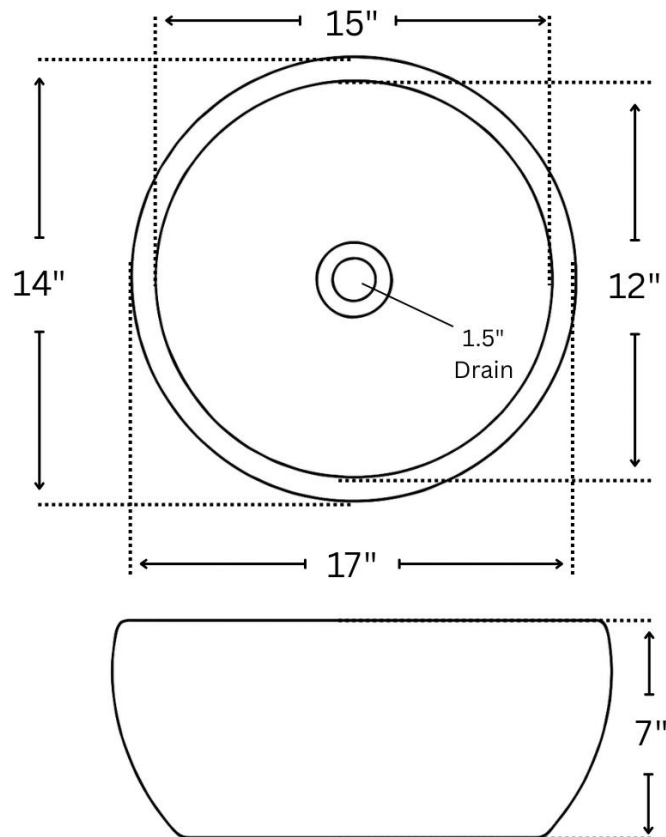

Mounting Options

- Vessel Mount

Overflow

- No overflow

Minimum Base Cabinet Width

- 2" the width of the sink intended for proper support (19")

Note: Due to the handcrafted nature of this product, it will vary in finish, texture, hammering, and other details. Dimensions may vary up to 1/4" (6mm). We strongly recommend waiting for the actual product before making any installation cuts.

Contact us at customerservice@thompsontraders.com or (336) 272-3003.

Thompson reserves the right to make revisions without notice to product specifications.

For the most current Specification Sheet, go to www.thompsontraders.com